



Surface Mount Underwater Light

Model 01 is an extraordinary light for its size and price. Incredibly compact, yet the brightest of its class, offering stunning performance and exceptional water penetration.

Available in 2 vibrant colors and a brand new Full-Color version with high-power LEDs and bespoke optics, the Model 01 is designed to fill your evenings with light.

At just 10mm thickness, the innovative housing materials provide exceptional durability and heat management – they also meet the UL94 standard for safety of flammability.

Model 01 has a smart on-board processor, internal drivers and advanced electronics that extend its lifespan and optimize the light output.

- > High-Power LEDs
- > Made of innovative materials
- > Surface-mount | Simple Installation
- > Incredibly compact size
- > On-board processor
- > Active Thermal Protection
- > Internal Drivers
- > EMC Tested & Certified
- > Impact & UV-Resistant

<p><b>1500</b> FIXTURE LUMENS</p>	<p><b>10mm</b> Super Thin Profile</p>
<p><b>12V</b> DC VOLTAGE</p>	<p><b>60°</b> UNIFORM BEAM</p>



VERSION	FIXTURE LUMENS	SKU
○ Sparkling White	1500	01-WW19A
● Deep Blue	1500	01-BB19A
● Full Color RGB	1260	01-CC25A
○ Sparkling White - Black Body	1500	01-WW19A-BL
● Deep Blue - Black Body	1500	01-BB19A-BL
● Full Color RGB - Black Body	1260	01-CC25A-BL

ACCESSORIES	SKU
<b>RF REMOTE</b>	YRF-400
<b>BASIC HUB</b>	YHB-400
<b>ON/OFF Switch</b> up to 6 fixtures	YSW-100

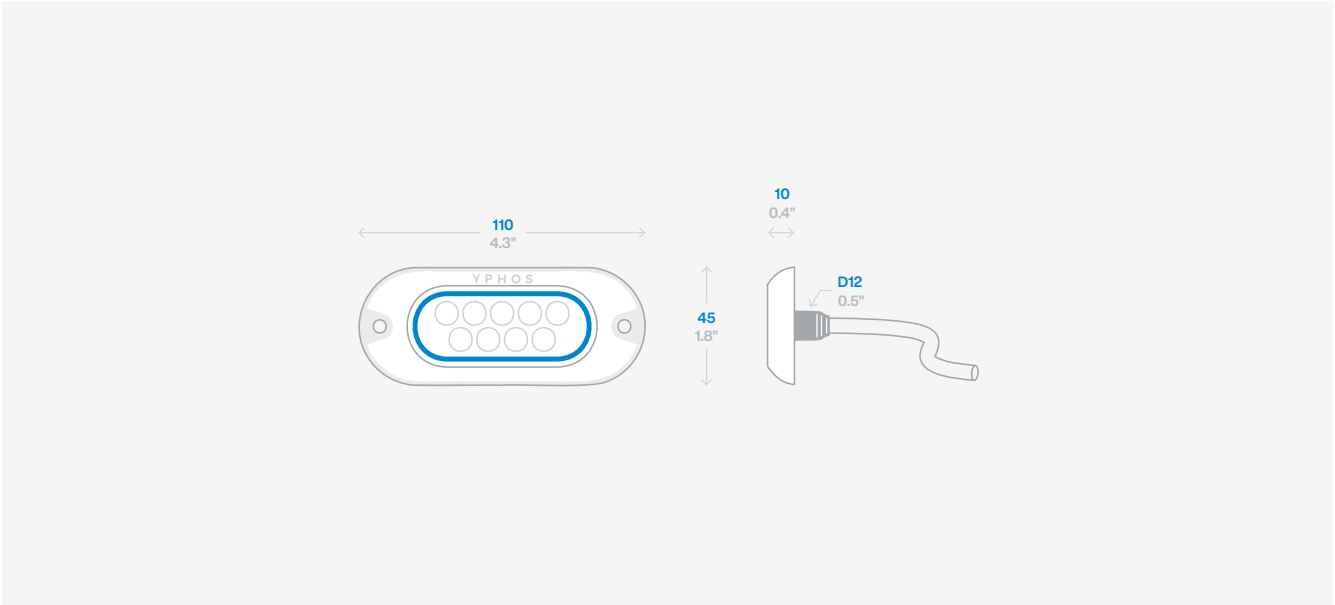

**Lighting**

**Fixture Lumens**  
1,500 Fixture Lumens (White)

**Typical LED Lifespan**  
70,000+ hours, compliant to L-80

**Beam Angle**  
60°

**Light Source**  
Gen. 4 YPHOS lighting module with Cree (USA) LEDs

**Electrical**

**Operating Voltage**  
12V DC (9.9V - 15V DC)

**Current Draw (DC)**  
1.4 Amp

**Driver Type**  
Internal Driver

**Cable Length**  
6ft (2m) waterproof cable

**Mechanical**

**Material**  
UV-Resistant, Marine Grade PC

**Weight**  
148 g

**Dimensions**  
110 x 45mm

**Hole cut-out for cable entry**  
9/16" | 14mm

**Technologies**

- Active Thermal Protection
- Reverse Voltage Protection
- Low Voltage Protection
- Soft Start-Up
- Inrush current Protection
- Surge Protection
- Noise Suppression

**Mounting**

- Boat size**  
up to 50ft - 15m
- Transom Quantity**  
2-6 Fixtures
- Installation Depth**  
6 - 10" (150 - 250mm) from water level
- Bonding**  
Not required

**Box Contents**

- Model 01 Light Fixture  
with 2m/6ft pre-wired cable
- Installation Manual
- Self-adhesive mounting template
- 2 Amp. blade fuse
- 2 x Mounting Screws

